

Halo

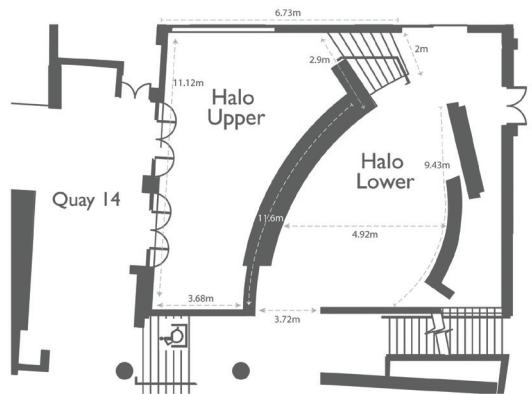

The newly redesigned Halo room provides a distinctive and intimate setting, perfect for private lunches or dinners for up to 80 guests, or standing cocktail receptions for up to 120. It serves as an ideal venue for weddings, engagement parties, retirement celebrations, or milestone birthdays, offering a memorable backdrop for special occasions.

The room features high ceilings that rise to the second floor, a striking Birdman sculpture, and a commanding painting by Clea Van Der Grijn, creating an impressive visual impact. Oversized mirrors and lamps are thoughtfully placed alongside a mix of modern and antique tables, blending classic and contemporary elements. The burnt orange walls and wooden floors add warmth to the space, which can be styled and adapted for any event. This combination of versatility and charm makes Halo a perfect choice for private dining, special celebrations, or corporate events.



Theatre Classroom U-Shape Boardroom Cabaret Banquet Reception

Dimensions
& Capacity

• • •

• • •

• • •

• • •

• • •

80

120

Ormond Quay, D1, D01 K5X5 www.morrisonhotel.ie
Contact us at +353 1 887 2458 or at events@morrisonhotel.ie

[f @MORRISONHOTELDUBLIN](https://www.facebook.com/MORRISONHOTELDUBLIN) [@MORRISONDUBLIN](https://www.instagram.com/MORRISONDUBLIN) [@MORRISONDUBLIN](https://www.linkedin.com/company/MORRISONDUBLIN)

morrison
DUBLIN
CURIO COLLECTION
by Hilton